

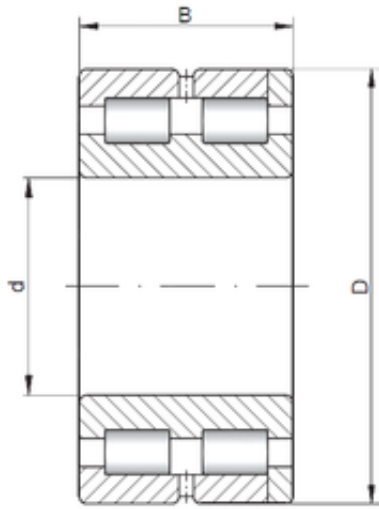

BROWNING BEARINGS MANUFACTURE LIMITED



340 mm x 460 mm x 118 mm ISO SL014968
cylindrical roller bearings

Bearing No. SL014968

Size	340x460x118 mm
Bore Diameter	340 mm
Outer Diameter	460 mm
Width	118 mm
d	340 mm
D	460 mm
B	118 mm
C	118 mm

SL014968 Bearing 2D drawings and 3D CAD models