

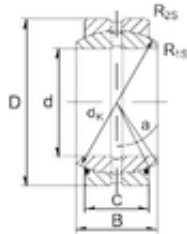

60 mm x 90 mm x 44 mm ZEN GE60ES plain bearings



Bearing No. GE60ES

Size	60x90x44 mm
Bore Diameter	60 mm
Outer Diameter	90 mm
Width	44 mm
d	60 mm
D	90 mm
B	44 mm
C	36 mm
dk	80 mm
r1 min.	1 mm
r2 min.	1 mm
Angle	6 °
Weight	1,04 Kg
Basic dynamic load rating (C)	245 kN

GE60ES Bearing 2D drawings and 3D CAD models